

oakheart



£1,195 Per Month

Per Month

Hardie's Point, Colchester

This two-bedroom second-floor apartment is situated in the Hythe Quay area. Benefitting from being within easy walking distance of Hythe Station for convenient city links as well as large Tesco superstore, the property also offers excellent access to Colchester Town Centre and the University of Essex.

Well-presented throughout, the accommodation

comprises of a generous lounge/diner with access to a balcony. Impressively contemporary, the kitchen is fitted with a range of sleek white units with an integrated oven, washer/dryer and dishwasher. Providing two double bedrooms, of which the master bedroom boasts a modern en-suite shower room and a stunning bathroom suite including a bath with shower fixture, built-in storage and a large wall-mounted mirror.

The accommodation benefits from a balcony for additional seating/dining area in a private outdoor space, as well as underfloor heating, a communal lift and allocated parking with visitors parking.

Available Late August. Call the Oakheart Lettings Team today now!







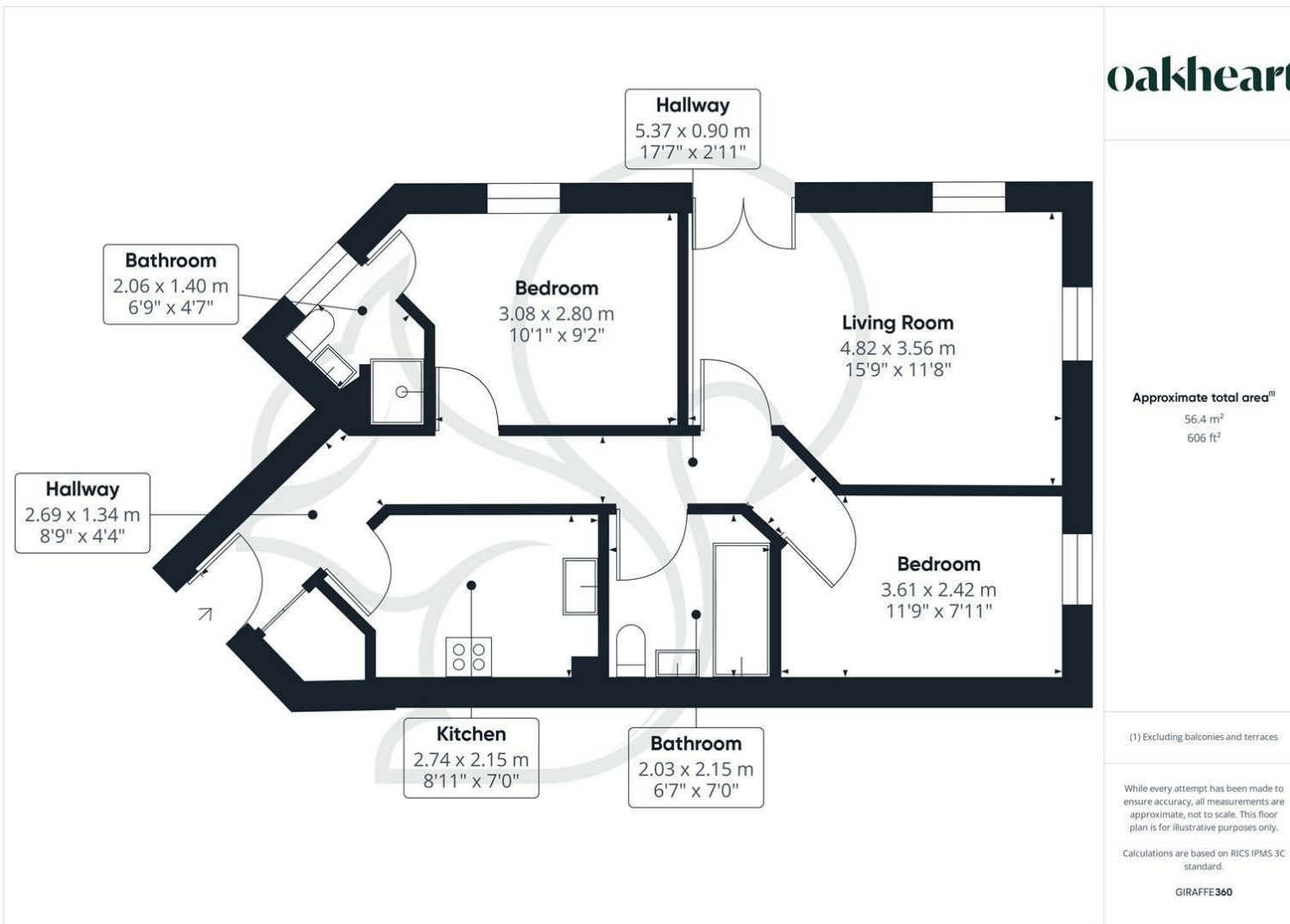

Local Authority:
Colchester Borough

Tenure:

Council Tax Band:
B

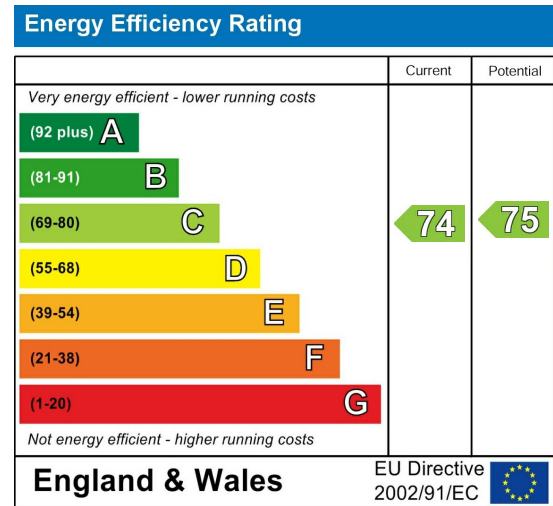

Agents Note: Whilst every care has been taken to prepare these particulars, they are for guidance purposes only. All measurements are approximate and are for general guidance purposes only and whilst every care has been taken to ensure their accuracy, they should not be relied upon.